

Residential
Light Commercial
Applications

HGEN-100 Service Entrance Rated Generator Transfer Switch Surge Protector

HGEN-100 Overview

The **HGEN-100** is designed to be the first line of defense against damaging electrical surges and spikes originating from utility power lines. The GEN-160-SER is UL1449 4th edition listed and designed for installation at the Utility Entrance side of the generator transfer switch providing robust protection for both the transfer switch and the whole home against damaging electrical surges and spikes.



HGEN-100 Transfer Switch Protector Features

- UL 1449 4th edition type 1 listed
- Flush mount plate option available for finished walls
- 100,000 Surge Amp Capacity with dual mode MOV and GAS-TUBE technology
- Thermal fused metal oxide varistor (MOV) suppression technology
- Light-emitting diode (LED) visual indicator for transfer switch protection status
- Type 06 Enclosure suitable for transfer switches installed inside or outdoors
- Provides whole house surge protection
- lifetime warranty with \$100,000 down line protection coverage



8535 Phoenix Drive,
Manassas VA 20110
Phone: 800-648-6802
www.surgeprogram.com

HGEN-100 Service Entrance Rated Generator Transfer Switch Surge Protector

HGEN-100 Specifications

Electrical

Model	HGEN-100	
Surge Protection Device (SPD) Type to UL	Type 1 Service Entrance Rated	
Operating AC Voltage	120/240V Single Phase 3W+G	
Maximum Continuous Operating AC Voltage (MCOV):		
Line-Neutral	140 V	
Line-Ground	140 V	
Neutral-Ground	140 V	
Line-Line	280 V	
Nominal Discharge Current [I _n]	20 kA	
Maximum Surge Current Capacity [I _{max}]:		
Line-Neutral	80 kA	
Line-Ground	80 kA	
Neutral-Ground	80 kA	
Line-Line	100 kA	
Fault Current Rating	10kA No Breaker 200ka With Breaker	
Voltage Protection Rating (VPR):		
Line-Neutral	600 V	
Line-Ground	1000V	
Neutral-Ground	600 V	
Line-Line	1000V	
Suppression Technology	MOV	
Listing	UL 1449 4th Edition Type 1	

Mechanical

Connection Terminal (Suppression) Hardwired	#12 AWG pigtail leads
Operation Temperature (°C)	-40° C to +80° C
Enclosure Type (Outdoor)	Type 4 PVC Plastic
Enclosure Dimension (L x W x H)	4.0 x 3.46 x 2.35 [294.14 x 130.43 x 62.31mm]
Weight	2.5 lbs [1.81 kg]

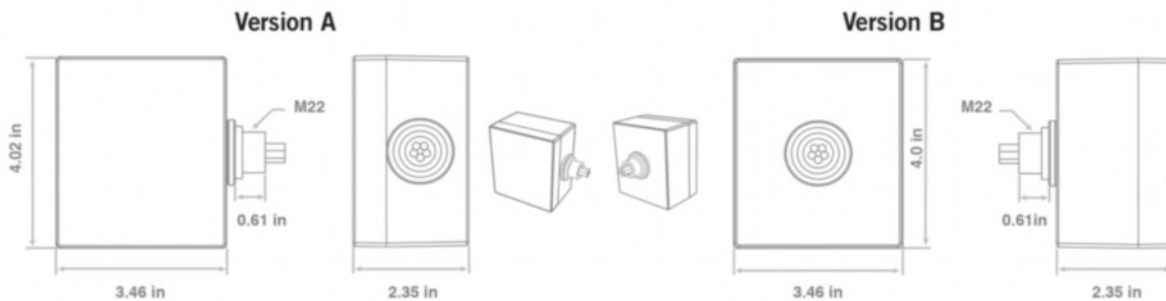

*NPT 1 / 2 adaptor available in both versions



8535 Phoenix Drive,
Manassas VA 20110
Phone: 800-648-6802

www.surgeprogram.com